

Meetings and Events



one exceptional venue

We understand how important it is that your event runs smoothly and at The Chester Grosvenor and Spa we ensure that it will. Take advantage of a selection of stylish rooms and suites with flexible layouts, natural daylight and complimentary WiFi access to address your meeting, events and private dining needs.

Westminster Suite

The newly refurbished Westminster Suite consists of the Belgrave and Aldford Suites. Spacious and versatile with its own entrance, cloakroom and bar, The Westminster Suite is a spectacular setting for any event.

Belgrave Suite

The muted colours and luxurious furnishings combined with the very latest technology, create a sophisticated venue ideal for making a great impression on clients, guests or delegates.

Aldford Suite

Made up of three adjoining boardrooms, this location is perfect if you need a flexible space that can be opened up or used as individual syndicate or private dining rooms.

Aldford Boardrooms

Stylish mahogany panelled walls and up to the minute plasma screens disguised as mirrors, provide an excellent setting for meetings, events or private dining.

The Eaton Suite - Executive Boardroom

The exceptionally stylish Eaton Suite – Executive Boardroom is one of the most inspiring meeting rooms dedicated to business. Bespoke contemporary boardroom furniture and state of the art technology, combined with an abundance of natural daylight and an adjoining private reception area, ensure that The Eaton Suite is the Northwest's premier destination for meetings of up to 20 delegates. The Eaton Suite boasts the very latest audio-visual equipment, inbuilt video conferencing facilities and complimentary Wi-Fi access.



THE CHESTER GROSVENOR AND SPA



Westminster Suite

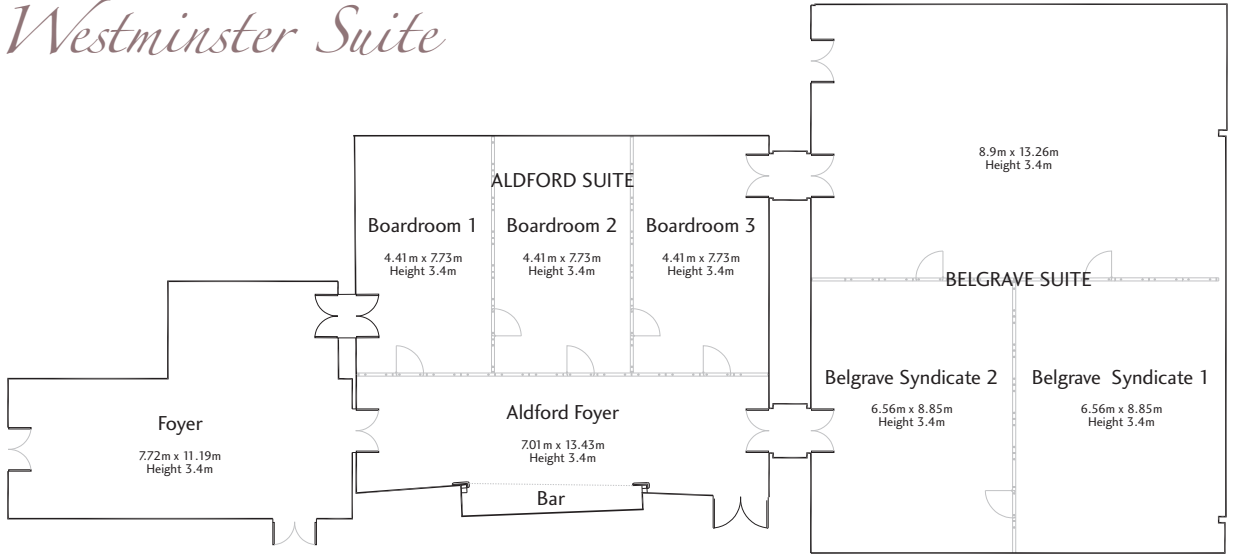

Capacity Chart

	Cabaret	Banquet	Dinner Dance	Reception	Theatre	Classroom	Boardroom
Belgrave Suite	108	228	144	320	250	120	-
Aldford Suite	40	58	48	60	120	60	36
Boardroom 1, 2 or 3	-	12	-	24	25	-	12
The Eaton Suite	-	-	-	-	-	-	20

The Eaton Suite - Executive Boardroom

